

Thermostats

Submitted by:

AI Lansdon 228

Honeywell [Aube TH115-A-240D 3600w 2-Pole Baseboard Thermostat](#)

Purchased from: SmartHome 800-762-7846

\$ 50.95

Phone: 949-477-5505

Address: 16542 Millikan Avenue, Irvine, CA 92606

Store Hours: Mon-Fri 9:00am - 5:00pm PT Sat: 10:00am - 2:00pm

SMARTHOME™

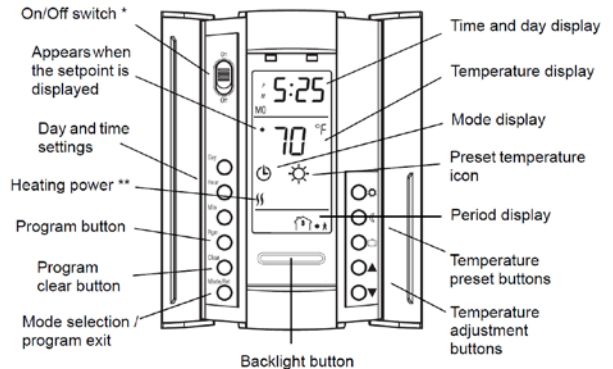

* Set the switch to Off to cut power to the heater. This will not affect the time and temperature settings.

** The thermostat displays the heater duty cycle required to maintain the desired temperature. For example, $\S\S$ appears when the heater is activated 40 percent of the time.

Summary: It was time to replace my 1978 thermostats. I did some research, and this seemed to be the best one that would match our system. It is a newer unit and I was very pleased with the quality. It also has a remote “add on” module for remote calling in. I was looking for the simple “vacation” setting to allow the cleaning person to easily turn down the heat setting when a guest leaves.

This thermostat has three heat settings that you program in first. (Comfort, Economy, & Vacation). It has 7 day programming and the common 4 settings per day. (Wake, Leave, Return, & Sleep). It has a feature that enables you to set every day the same, which made it simple to set for the whole week. You set the times for these 4 settings and they will use the “Comfort” and “Economy” heat settings. Setting 1 & 3 will use “Comfort” and setting 2 & 4 will use “Economy”. Pressing the Vacation button will place the thermostat in the lower setting indefinitely until someone presses another button.

The guest can always use the up and down arrows to change the heat setting.

Amazon = \$ 40.25 (8-20-11)

http://www.amazon.com/Aube-Honeywell-Electric-Programmable-Thermostat/dp/B0007UONQA/ref=sr_1_1?ie=UTF8&qid=1308612581&sr=8-1 – On Amazon (Now)

2 Assembly/Disassembly

- To remove the control module from the power base, loosen the captive screw underneath the thermostat and pull the two components apart as shown.
- To install the control module onto the power base, reverse the above procedure.

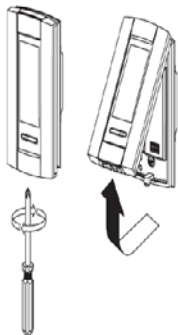

NOTE: Always keep the thermostat's vents clean and unobstructed.

Page 1 of 2

4 Power-up

Upon power-up, the thermostat is in manual mode (M) and displays the actual temperature.

- Press the Hour and Min buttons to set the time.
- Press the Day button to set the day.

5 Error Messages

LO: The measured temperature is below 32°F (0°C). Heating is activated.

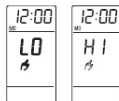

HI: The measured temperature is above 122°F (50°C).

6 Backlight

When the backlight button is pressed, the display illuminates for 5 seconds. When either of the ▲▼ buttons is pressed, the display illuminates for 10 seconds.

8 Operating Modes

The thermostat has 3 operating modes.

Automatic - The temperature is set according to the energy-saving schedule. To place the thermostat in this mode, press Mode/Ret until ☺ is displayed. The current period setting is also displayed.

Temporary Bypass: If you modify the setpoint (by pressing the ▲▼, ☼ or ☾ button) when the thermostat is in automatic mode, the new setpoint will be used until the beginning of the next period.

Manual - The energy-saving schedule is not used. The temperature must be set manually. To place the thermostat in this mode:

- Press Mode/Ret until M is displayed.

- Set the temperature using the ▲▼, ☼ or ☾ button.

Vacation - The thermostat is set to the Vacation temperature. Press ☒ to place the thermostat in Vacation mode.

3 Configuration

Some thermostat configurations can be modified via the switches on the back of the control module.

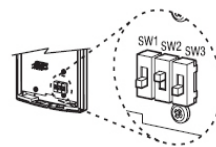

Default (factory) settings are inside the gray cells.

| # | Functionality | UP | DN |
|-----|---------------------------------|---------|---------|
| SW1 | Temperature format ^a | °F | °C |
| SW2 | Early Start ^b | Disable | Enable |
| SW3 | Time format | 12-hour | 24-hour |

- If you change the temperature display format, the preset buttons (☼, ☾ and ☒) will return to their default settings.
- Early Start functions in Automatic mode only. When this function is enabled, the thermostat calculates the optimal time to start heating in order to obtain the desired temperature by the set time. The thermostat re-assesses the start time daily based on the previous day's performance.

7 Temperature Setting

Setpoint

The thermostat generally displays the actual temperature. To view the setpoint, press one of the ▲▼ buttons once or press the backlight button. The setpoint will appear for the next 5 seconds.

To change the setpoint, press one of the ▲▼ buttons until the desired temperature is displayed. To scroll faster, hold the button.

Preset buttons

The thermostat has 3 temperature preset buttons:

- Comfort preset button ☼
- Economy preset button ☾
- Vacation preset button ☒

To use a preset temperature, press the appropriate button. The corresponding icon ☼, ☾ or ☒ will be displayed.

The following table shows the intended use and the default setting of each of the preset buttons.

| Icon | Intended use | Default setting | New |
|------|---|-----------------|-----|
| ☼ | Comfort (when at home) | 70°F (21°C) | |
| ☾ | Economy (when asleep or away from home) | 62°F (16.5°C) | |
| ☒ | Vacation (during prolonged absence) | 50°F (10°C) | |

To store a preset temperature:

- Set the desired temperature using the ▲▼ buttons.
- Press and hold the appropriate preset button until the corresponding icon is displayed.
- Press Mode/Ret to exit.

9 Energy-saving Schedule

The schedule consists of 4 periods per day which represents a typical week day. You can program the thermostat to skip the periods that do not apply to your situation. For example, you can skip periods 2 and 3 for the weekend.

| Period | Description | Associated temperature setting |
|--------|----------------|--------------------------------|
| ☺ | Wake-up | ☼ |
| ☺☺☺ | Away from home | ☾ |
| ☺☺☺☺ | Return home | ☼ |
| ☺☺ | Sleep | ☾ |

The Comfort (☼) temperature is used in periods 1 and 3 and the Economy (☾) temperature is used in periods 2 and 4. For example, when the period changes from 1 to 2, the setpoint automatically changes from Comfort setting (☼) to Economy setting (☾).

You can have a different program for each day of the week; i.e., each period can start at different time for each day of the week. The thermostat has been programmed with the following schedule.

| Period | Setting | MO | TU | WE | TH | FR | SA | SU |
|--------|---------|----------|----------|----------|----------|----------|----------|----------|
| ☺ | ☼ | 6:00 am | 6:00 am | 6:00 am | 6:00 am | 6:00 am | 6:00 am | 6:00 am |
| ☺☺☺ | ☾ | 8:00 am | 8:00 am | 8:00 am | 8:00 am | 8:00 am | --- | --- |
| ☺☺☺☺ | ☼ | 6:00 pm | 6:00 pm | 6:00 pm | 6:00 pm | 6:00 pm | --- | --- |
| ☺☺ | ☾ | 10:00 pm | 10:00 pm | 10:00 pm | 10:00 pm | 10:00 pm | 10:00 pm | 10:00 pm |

To modify the schedule:

- Press Pgm to access the programming mode. Period 1 is selected.
- Press Day to select the day to program (hold for 3 seconds to select the entire week).
- Press Hour and Min to set the start time of the selected period, or press Clear if you want to skip the period (--- is displayed).
- Press Pgm to select another period, or press Day to select another day. Then repeat step 3.
- Press Mode/Ret to exit the programming mode.

NOTE: If no button is pressed for 60 seconds, the thermostat will automatically exit the programming mode.